

SPECIFICATIONS

UFS has designed the S-Span Curved 36.5m wide profile to cover multiple courts for any sporting application.

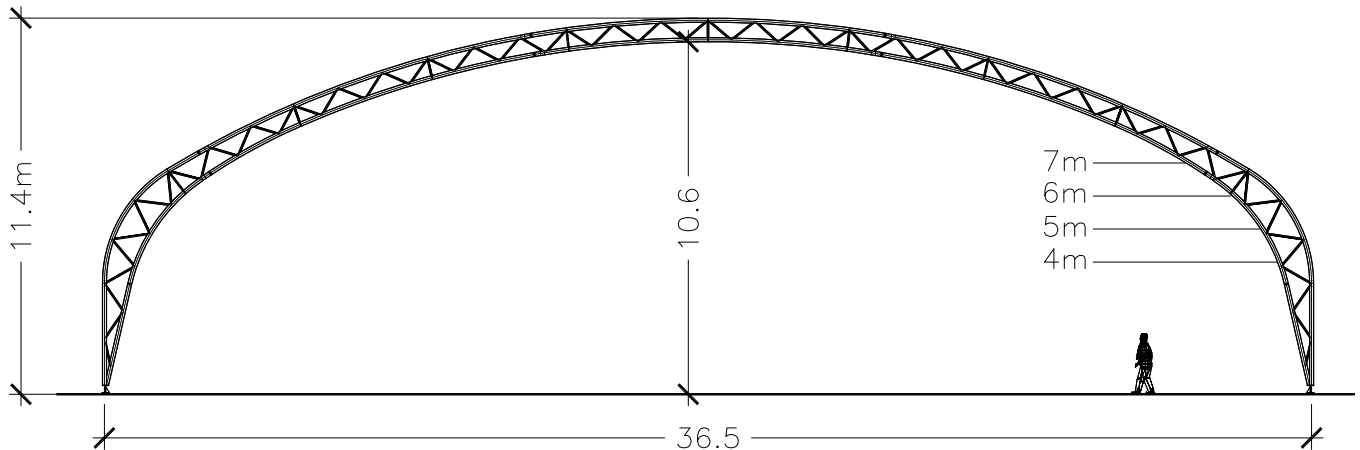

The S-Span-C has a steel truss frame and is designed to be for more permanent style applications, although it is still fully relocatable. The structure meets Australian standard height, width, and length requirements for competition sports.



PRICING ESTIMATES FOR S-SPAN-C 36.5M

The pricing estimates listed below are for supply of frame, PVC fabric, and all connection hardware with fabric to ground and full end walls. Installation, footings, and accessories are not included. Installation is approximately \$30-\$40 per m2, subject to access and location.

Note: Pricing estimates are in Australian Dollars and are exclusive of GST.

# Courts *	Length	Plan Area	Price	\$/m2
2	36	1314	\$283,000.00	\$215.37
3	54	1971	\$364,177.28	\$184.27
4	72	2628	\$460,000.00	\$175.04
5	90	3285	\$532,894.10	\$162.22
6	108	3942	\$613,654.76	\$155.67

* Can cover as many courts as required. Please contact Universal Fabric Structures for pricing.



For more information

Call Toll Free: 1300 COVERME (1300 268 376)

Email: info@fabricstructures.com.au

www.fabricstructures.com.au

Universal Fabric Structures

www.fabricstructures.com.au - info@fabricstructures.com.au - 1300 COVERME (1300 268 376)